

MSL1003

CRI 80 5000K 1400Lumens LED Security Light

Elitco Lighting



The high performance LED Security Light architectural form and versatility to make it an excellent choice for new construction or retrofit applications.

Performance

- LED Canopy is designed to provide 50,000 hours of life
- UL compliant, for use in Wet locations



Construction

- Die -cast aluminum housing with durable paint finish
- Plastic optical lens is protected by gasket lined tempered PC cover

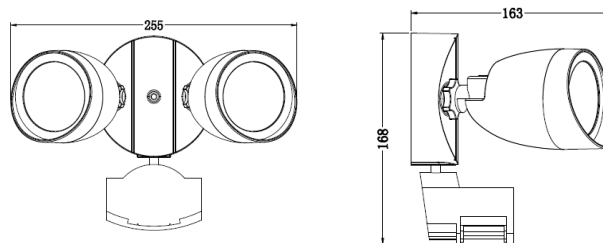

Installation

- LED Security Light wall mount
- Size: L10.04"(255mm)*H6.61"(168mm) *W6.89"(175mm)

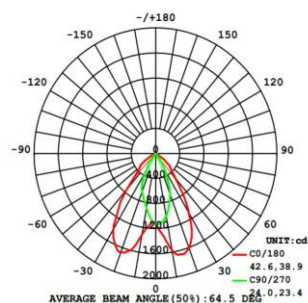

Specifications

| | | | |
|---|-----------------------|--------------------------------------|---------------|
| Category | Motion Security Light | Individual Box Length (Inch) | 11.46 |
| Bulb Shape | Round | Individual Box Width (Inch) | 7.68 |
| Bulb Base Type | Integrated LED | Individual Box Height (Inch) | 7.28 |
| Bulb Base Finish | N/A | Individual Box Weight Per Unit (Lbs) | 3.18 |
| Color Temperature | 5000K | Carton Package Length (Inch) | 38.98 |
| Beam Angle | 270° | Carton Package Width (Inch) | 12.24 |
| Finish | White | Carton Package Height (Inch) | 8.07 |
| CRI | 80 | Carton Package Weight Per Unit (Lbs) | 15.98 |
| Average Life (Hours) | 50000 | Carton Quantity | 5 |
| Estimated Yearly Energy Cost (11 ¢/Kwh) | 2.41 | Lamp Type | LED |
| Life Based On 3Hrs/Day (Years) | 45.66 | Dry/Wet/Damp | Wet |
| Product Length (Inch) | 10.04 | Energy Star | YES |
| Product Width (Inch) | 6.89 | Power Factor | 0.9 |
| Product Height (Inch) | 6.61 | Current | 200mA |
| Product Extension (Inch) | N/A | Lumen/Watt | 70 |
| Product Weight Per Unit (Lbs) | 2.43 | Warranty (Year) | 5 |
| Dimmable | NO | DLC (Yes/No) | No |
| Watts | 20W | Input Voltage | 120V-277V |
| Watt Equivalent | N/A | Housing Material | Aluminum |
| Lumens | 1400 | Lens | Polycarbonate |
| Certification (UL/ETL/FCC) | UL | Led Type | LG 3030 |